

Contactless lift solution

The logo for DATS, featuring the letters 'D', 'A', 'T', and 'S' in a bold, sans-serif font. The 'D', 'T', and 'S' are blue, while the 'A' is a dark grey color with a white triangle cutout in its center.

- Application scenarios: lift/elevator hall call and lift/elevator car
- Device installation: External adhesive installation. Installation position and installation method are optional
- How to use: No need touch lift button. What you need is using you finger point to the corresponding button. Corresponding button will be brighten, avoid the risk of cross infection



Product parameters



Item	Parameters
Floor numbers	Maximun floors is 42 floors & maximum buttons is 200 pcs
Work temperature	-30°C~60°C
Spare parts	Main control board and contactless button panel
Panel size	100*38*5 mm
Voltage	9-36V

Product function parameters

Hall call master board



Auto recognize external panel type
Receive external panel signal and realize call lift
Support button panel light control
Master board support 72-241/ power supply
Support buzzer and power indicator light
Master board:
56.84mm*707.84mm*27mm

Hall call panel



Support receiving light control
Support sensor information upload
Deputy board support 51/ power supply
Sensor sensing distance: 3cm-5cm
Hall call panel:
10L6mm*44.2mm*5.55mm

Car master board



Support power indicator light and configuration
Support button panel identification
Master control board support 72-241/ power supply
Support 1CH 485 connect elevator control
Car master board:
724mm*88mm*29mm

Architecture diagram

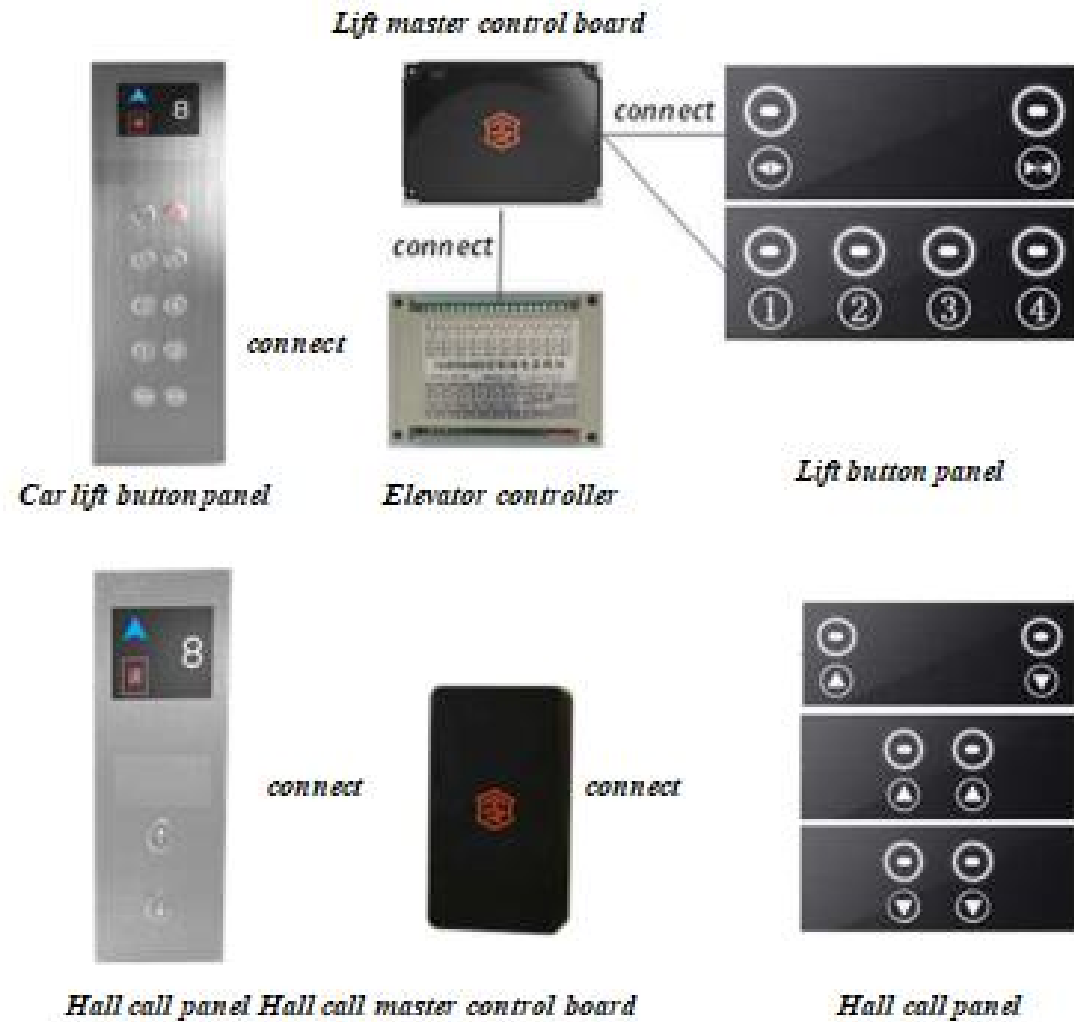

Samples for COP & LOP



Floor button panel



DO & DC button panel

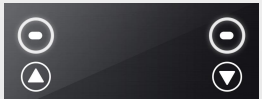

UP & DOWN button panel for LOP

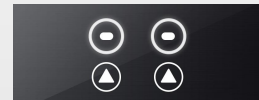

Call button panel for first floor

